

Häfele Free Space



→ Free Space 1.8 Push to Open

- > For doors without handle
- > For door heights: up to 650 mm (26")
- > Height/side/tilting angle and holding power
- > Max. door overlay: 90° opening: 37 mm (1 1/4")
107° opening: 22 mm (7/8")
- > Screw mounts with pre-mounted euro screw, door panel mounts without tools and slides onto pre-mounted screws
- > Material: Housing: Plastic; Mounting Bracket and Support Lever: Steel; Finish: nickel-plated

Model	white	light gray	anthracite
B	372.27.705	372.27.505	372.27.355
C	372.27.706	372.27.506	372.27.356
D	372.27.707	372.27.507	372.27.357
E	372.27.708	372.27.508	372.27.358

Supplied With

- Fitting set (1 pc. each left/right)
- 4 Fixing screws for front panel
- Free push catch
- Installation instructions with paper drilling template for side panel

Note

The choice of fitting depends on the cabinet height and door weight.

We recommend ordering the stronger fitting model if in doubt. Please order screw set 372.27.600 for aluminum frame front panels with frame width from 45 mm (1 3/4").

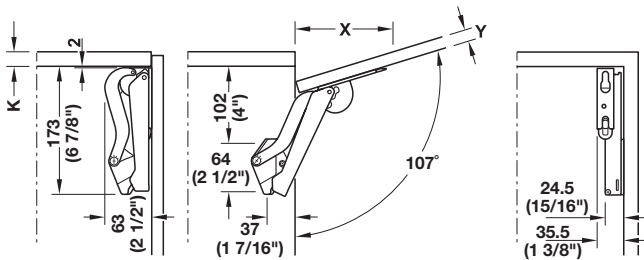

Front panel thickness Y	16 (5/8")	19 (3/4")	22 (7/8")	26 (1")
Distance X (with cabinet top panel thickness 16 mm (5/8"))	117 (4 5/8")	107 (4 1/4")	96 (3 7/8")	83 (3 1/4")

Note Dim X helps calculate space required when raised panels or crown moldings are used.

Measurements table for selecting the right model based on cabinet height and door weight including weight of handle
We recommend ordering the stronger fitting model if in doubt.

Model	Door Weight Ranges in Pounds							
	B		C		D		E	
Door Height	Min	Max	Min	Max	Min	Max	Min	Max
225 (9")	5.1	9.5	8.4	15.6	14.1	20.5	20.2	29.5
250 (10")	4.2	8.6	7.5	14.1	12.8	20.0	18.3	27.7
275 (11")	4.2	7.7	6.8	12.8	11.7	18.0	16.5	26.4
300 (12")	3.7	7.0	6.2	11.7	10.6	16.5	15.2	24.2
325 (13")	3.5	6.6	5.7	10.8	9.7	15.4	14.1	22.4
350 (14")	3.3	6.2	5.3	10.1	9.0	14.3	13.0	20.9
375 (15")	2.9	5.7	4.8	9.5	8.4	13.2	12.1	19.4
400 (16")	2.6	5.3	4.6	8.8	7.9	12.3	11.4	18.3
425 (17")	2.4	5.1	4.4	8.4	7.5	11.7	10.8	17.2
450 (18")	2.2	4.6	4.2	7.7	7.0	11.0	10.1	16.1
475 (19")	2.2	4.4	4.0	7.5	6.6	10.3	9.5	15.4
500 (20")	2.0	4.2	3.7	7.0	6.4	9.9	9.0	14.5
525 (21")	2.0	4.0	3.5	6.6	5.9	9.5	8.6	13.9
550 (22")	1.8	3.7	3.3	6.4	5.7	9.0	8.1	13.2
575 (23")	1.8	3.7	3.1	6.2	5.5	8.6	7.9	12.5
600 (24")	1.8	3.5	3.1	5.9	5.3	8.1	7.5	12.1
625 (25")	1.5	3.3	2.9	5.5	5.1	7.9	7.3	11.7
650 (26")	1.5	3.3	2.9	5.3	4.8	7.7	7.0	11.2

Order suitable screw set for aluminum frame doors, previous page.

Dimensional data not binding. Dimensions in mm, inches are approximate. We reserve the right to alter specifications without notice.