

# American Standard

## SELECTRONIC™ PROXIMITY TOILET FLUSH VALVE 1.1, 1.6 & 1.28 GPF

### PRODUCT NUMBERS

6065.161	6065.162
6065.121	6065.122
6065.565	6065.525
6065.111	7095.121

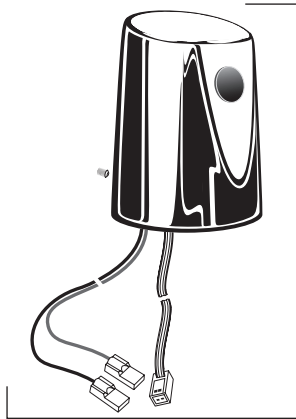

**M962665-0021100A**  
COVER ASSEMBLY FOR  
FLUSH VALVE WITH 1.1 gpf  
(BATTERY INCLUDED)

**M962665-0021600A**  
COVER ASSEMBLY FOR  
FLUSH VALVE WITH 1.6 gpf  
(BATTERY INCLUDED)

**M962665-0021280A**  
COVER ASSEMBLY FOR  
FLUSH VALVE WITH 1.28 gpf  
(BATTERY INCLUDED)



**A923654-0070A**  
BATTERY 6VCR-P2

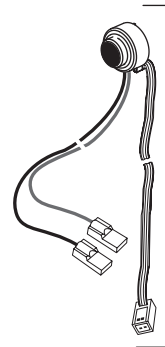

**A950223-0071600A**  
SENSOR ASSEMBLY  
W/MTG. KIT.  
FOR FLUSH VALVE  
WITH 1.6 gpf

**A950223-0071280A**  
SENSOR ASSEMBLY  
W/MTG. KIT.  
FOR FLUSH VALVE  
WITH 1.28 gpf

**A950223-0071100A**  
SENSOR ASSEMBLY  
W/MTG. KIT.  
FOR FLUSH VALVE  
WITH 1.1 gpf

**A906680-0070A**  
BONNET NUT



**M962664-0070A**  
SOLENOID ASSEMBLY

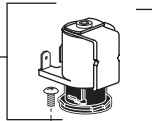

**M962956-0070A**  
SOLENOID & PISTON  
SUBASSEMBLY

**M962663-0070A**  
PISTON ASSEMBLY

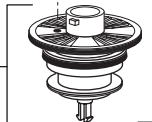

OPTIONAL ADJUSTABLE TAILPIECE  
(Purchased Separately)

**M962836-0020A** (8-1/4" to 9-1/4" Rough-in)

**M962835-0020A** (7-1/4" to 8-1/4" Rough-in)

**M962834-0020A** (6-1/4" to 7-1/4" Rough-in)

**M962833-0020A** (5-1/4" to 6-1/4" Rough-in)



**M962920-0020A**  
ADJUSTABLE TAILPIECE  
(4-1/4" to 5-1/4" Rough-in)

**M962666-0020A**  
MANUAL VALVE



**M962928-0020A**  
STAMPED FLANGE



**M962927-0020A**  
COVER TUBE

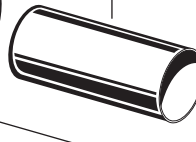

**M962926-0070A**  
SWEAT ADAPTER

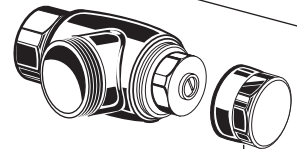

**A955056-0020A**  
1" SUPPLY STOP

**A955057-0020A**  
INLET PIPE ASSEMBLY



**A955054-0020A**  
VACUUM BREAKER  
ASSEMBLY 11-1/2"  
(220mm) ROUGH-IN

**A955068-0020A**  
VACUUM BREAKER  
ASSEMBLY 27"  
(610mm) ROUGH-IN

**M964059-0020A**  
CAP (40mm TREAD)



**M952269-0020A**  
ESCUTCHEON KIT



HOT LINE FOR HELP  
For toll-free information and answers to your questions, call:  
1 (800) 442-1902  
Weekdays 8:00 a.m. to 6:00 p.m. EST  
IN MEXICO 01-800-839-1200  
IN CANADA 1-800-387-0369 (TORONTO 1-905-306-1093)  
Weekdays 8:00 a.m. to 7:00 p.m. EST

Product names listed herein are trademarks of AS America, Inc.