



**LITHIUM IRON PHOSPHATE BATTERY**

The Fortress Power eFlex is a 5.4 kWh scalable energy storage solution based on safe and energy dense prismatic Lithium Iron Phosphate cells. The digital processor Battery Management System (BMS) includes high amperage contactor disconnects and advanced closed loop inverter communication, as well as individual cell voltage monitoring, temperature monitoring, and cell balancing to maximize reliability and longevity. Canbus, modbus, and wifi communication enable internet-of-things compatibility. The IP65 case ensures direct water spray and dust will not penetrate the battery internals from all directions. The unit can be wall mounted, floor mounted, and server rack mounted for hard-to-reach access in renewable, marine, RV, mobile, telecom, railway applications and more!

- 98% Roundtrip efficiency
- IP65 Dust and Water Proof Design
- Safest Lithium Technologies (LiFeP04) on the market
- Flexible mounting options

- Data communication with popular hybrid inverters
- Remote monitoring
- Advanced cell level monitoring and balancing
- Integrated heat sink for 5x better thermal performance

| Electrical Specifications            |              |
|--------------------------------------|--------------|
| Nominal Voltage:                     | 51.2V        |
| Nominal Capacity:                    | 105AH        |
| Rated Capacity @ 0.5C (50A):         | 5,374 kWh    |
| Resistance:                          | <10 mΩ       |
| Efficiency (at 0.5C):                | 98%          |
| Self-Discharge:                      | <1 % / Month |
| Maximum Allowed Modules in Parallel: | 15           |

| Charge Specifications          |       |
|--------------------------------|-------|
| Recommended Charge Current:    | <55A  |
| Maximum Charge Current:        | 100A  |
| Recommended Charge Voltage:    | 54.4V |
| BMS Charge Voltage Disconnect: | >56V  |

| Discharge Specifications               |                    |
|--|--------------------|
| Recommended Continuous Discharge Rate: | 60A (3KW DC)       |
| Peak Continuous Discharge Rate:        | 100A (5 KW 60 Min) |
| Maximum Surge Power Rate:              | 130A (6.6 KW 5S)   |
| Recommended Low Voltage Disconnect:    | 48V                |
| Battery Low Voltage Protection:        | <45V               |
| Battery recovery Voltage:              | 45V                |

| Temperature Specifications |                           |
|----------------------------|---------------------------|
| Discharge Temperature:     | -4°F~131°F (-20°C ~ 55°C) |
| Charge Temperature:        | 32°F ~ 114°F (0°C ~ 45°C) |
| Storage Temperature:       | 20°F ~ 95°F (-6°C ~ 35°C) |

| Mechanical Specifications |                                    |
|---------------------------|------------------------------------|
| Dimensions: (L*W*H)       | 18x23x7.3 inches<br>446x546x183 mm |
| Weight:                   | 108 lbs (49kg)                     |
| Terminal Type:            | M8                                 |
| Ring Terminal Size:       | 3/8ths or larger                   |
| Terminal Torque:          | 7.0 – 7.7 Nm<br>(5.1 – 5.7 ft-lb)  |
| Case Material:            | Anodized Aluminum                  |
| Enclosure Protection:     | IP65                               |
| Cell Type Chemistry:      | Prismatic - LiFeP04                |

| Compliance Specifications: |  |
|----------------------------|--|
| Certifications:            | UL 9540, UL 9540A, UL1973, UL1642        |
| Shipping Classification:   | UN 38.3 CLASS 9<br>(Lithium Ion Battery) |

| Basic Charging Profile   |  |
|--------------------------|--|
| Bulk + Absorb Charge     | 54.4V  |
| Absorb Time              | 60 minutes   |
| Float Charge             | 54V  |
| Inverter Charging        | 2 Stage / No Float                                       |
| Equalization             | No equalization (typical)<br>54.6V for 10 seconds (rare) |
| Temperature Compensation | None   |



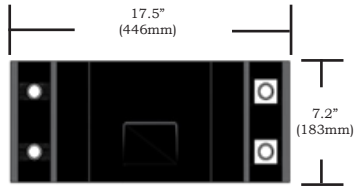

Front View

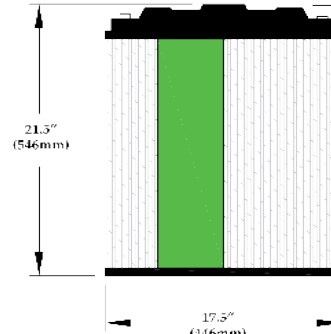

Top View



Side View

Wall Mount Bracket

Wall Mount Hook

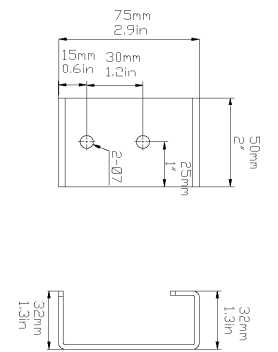
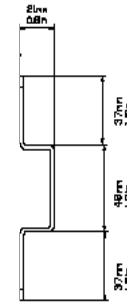
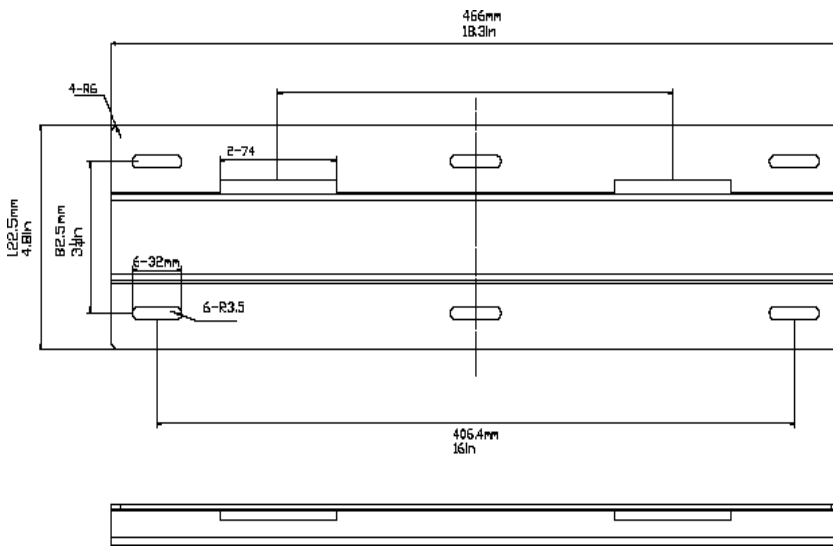

Server Rack Mount Bracket

