

Version: 12-2004

Mounting plate attachment

One piece assembly

COMPACT 38N wrap around

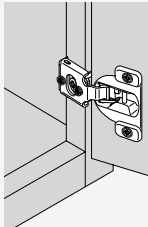

COMPACT 38C/39C wrap around

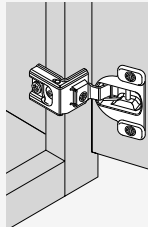

COMPACT 38 wrap around

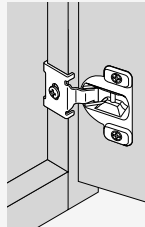

COMPACT 38A face mount

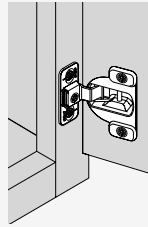

Two piece assembly

COMPACT 33 edge mount

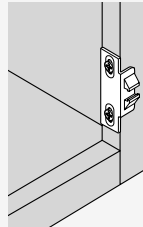

COMPACT 33 wrap around

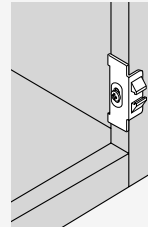

COMPACT 33 face mount

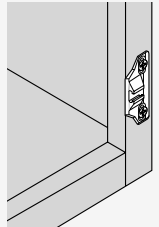

Hinge cup centerpoint

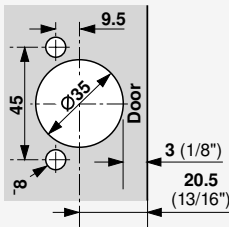

Cup centerpoint and MINI-PRESS / MINIDRILL setback position is 20.5 (13/16)\"/>

Minimum reveal

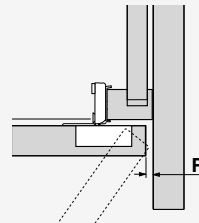

A minimum reveal per door is required to keep the door from binding and varies depending on door thickness (see Minimum reveal table for each hinge).

Three-way independent adjustment

Side adjustment

Side adjustment possible on all COMPACT hinges except 38. series. COMPACT 38C/39C have cam side adjustment.

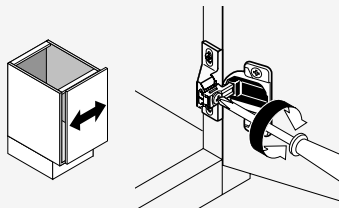

Depth adjustment

COMPACT 38N, 38C and 39C have cam depth adjustment.

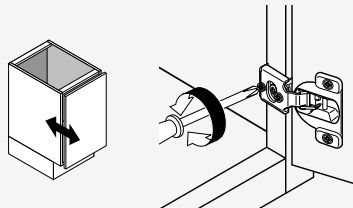

Height adjustment

All COMPACT hinges are independently height adjustable.

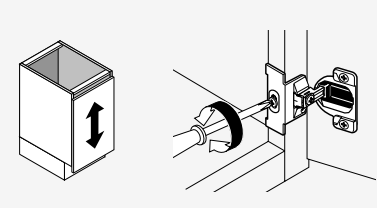

One piece mounting plate

Hinge dimension abbreviations

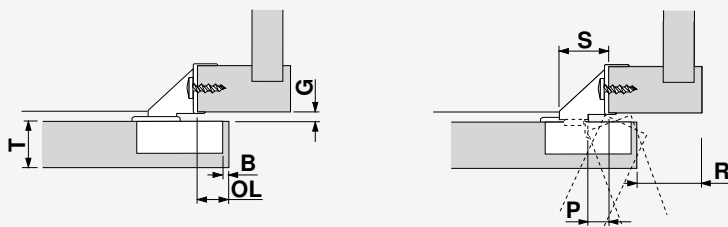

- B = Boring distance
- OL = Door overlay
- G = Door gap
- P = Door protrusion (at max. opening)
- R = Reveal
- S = Hinge arm protrusion
- T = Door thickness

Hinges per door

X = Door height
 Y = Number of hinges

This chart can serve as a guide for determining the number of hinges per door. Note that door weight can also determine the number of hinges required.

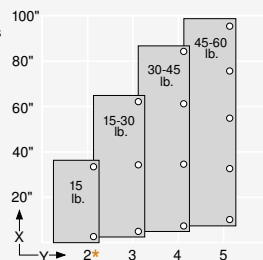

* The distance between the two hinges must be greater than the width of the door for maximum stability.