

Table Legs

- > Leg screws into steel square mounting plate with M10 bolt
- > Levelers are pressed-in, they can be removed and pounded back in if legs need to be cut
- > Adjustment range: +25 mm (1")
- > Static weight rating: approximately 100 kg (220 lbs.) per leg
- > Height includes mounting plate and leveler
- > With adjustable foot: +25 mm (1")
- > Height: 710 mm (28")
- > Material: Legs: Steel, plated or epoxy-coated
Leveler: Plastic; Color: black
Mounting Plate: Steel; Color: black

→ E-Leg Ø76 (3")

6

Casters, Feet, Legs, Table Fittings

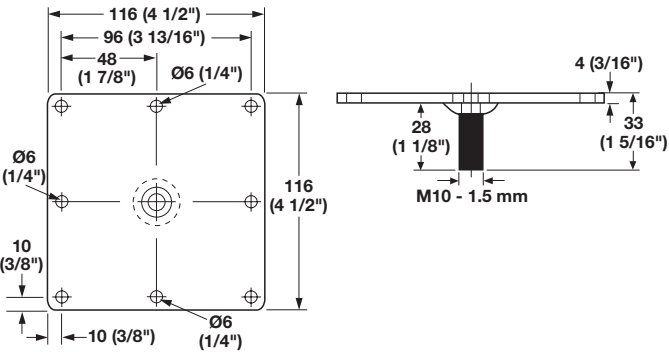
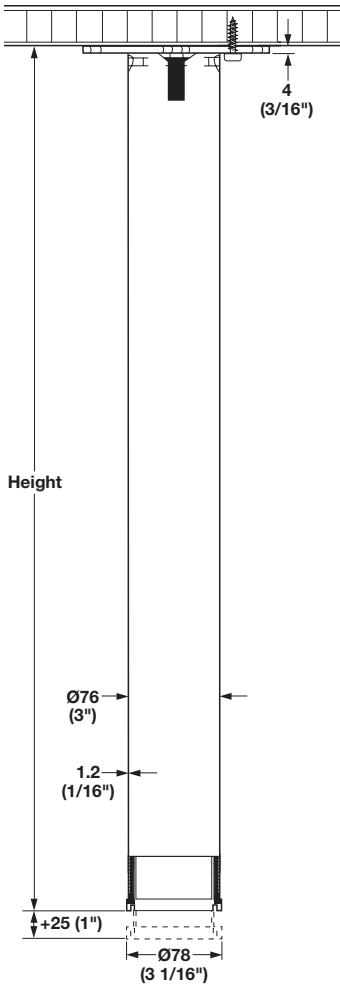

Finish	Item No.
polished chrome	635.53.271
black textured	635.53.372
satin nickel	635.53.471
silver aluminum RAL 9006	635.53.272

Supplied With
4 Legs
4 Mounting plates
Levelers
Screws #9 x 1"

Dimensional data not binding. Dimensions in mm, inches are approximate. We reserve the right to alter specifications without notice.