

Version: 12-2004

## Mounting plate attachment

### One piece assembly

COMPACT 38N wrap around

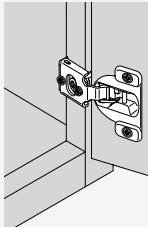

COMPACT 38C/39C wrap around

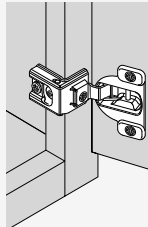

COMPACT 38 wrap around

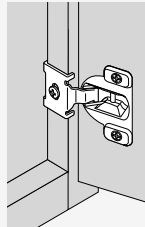

COMPACT 38A face mount

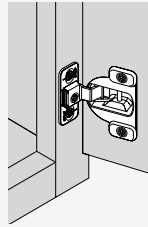

### Two piece assembly

COMPACT 33 edge mount

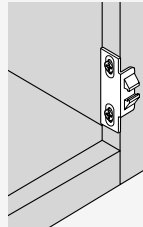

COMPACT 33 wrap around

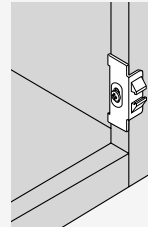

COMPACT 33 face mount

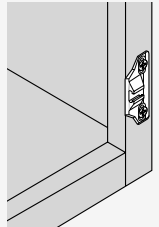

## Hinge cup centerpoint

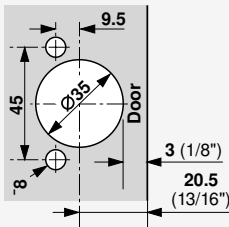

Cup centerpoint and MINI-PRESS / MINIDRILL setback position is 20.5 (13/16)\"/>

## Minimum reveal

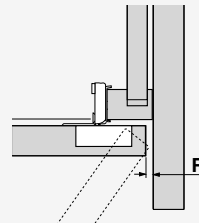

A minimum reveal per door is required to keep the door from binding and varies depending on door thickness (see Minimum reveal table for each hinge).

## Three-way independent adjustment

### Side adjustment

Side adjustment possible on all COMPACT hinges except 38. series. COMPACT 38C/39C have cam side adjustment.

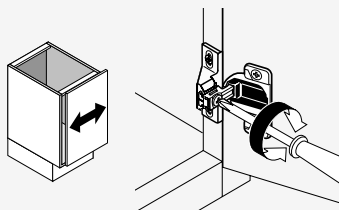

### Depth adjustment

COMPACT 38N, 38C and 39C have cam depth adjustment.

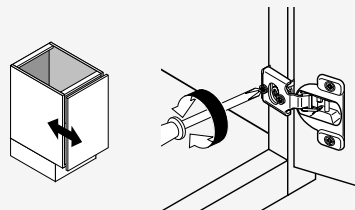

### Height adjustment

All COMPACT hinges are independently height adjustable.

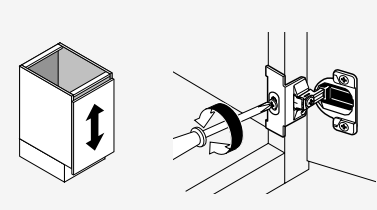

One piece mounting plate

## Hinge dimension abbreviations

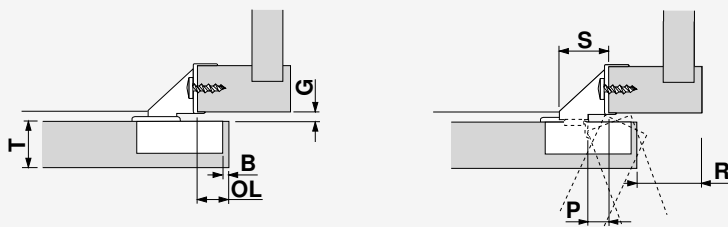

- B = Boring distance
- OL = Door overlay
- G = Door gap
- P = Door protrusion (at max. opening)
- R = Reveal
- S = Hinge arm protrusion
- T = Door thickness

## Hinges per door

X = Door height  
 Y = Number of hinges

This chart can serve as a guide for determining the number of hinges per door. Note that door weight can also determine the number of hinges required.

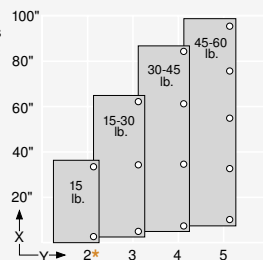

\* The distance between the two hinges must be greater than the width of the door for maximum stability.